

## Building Community-Based Resilient Housing in Thua Thien Hue, Vietnam

Authors: Le Ngoc Van Anh\*, Truong Hong Truong\*, Nguyen Ngoc Tung\*, Nguyen Trong Vinh\*, Dinh Ba Vinh\*\*, Ma Thao Huong\*\*

\* Architecture Faculty, University of Sciences, Hue University

\*\* Foundation for Supporting and Development of Sustainable Living Community (Sống Foundation)

### BACKGROUND & OBJECTIVE

Disadvantaged people are the most vulnerable community when facing natural disasters, because they lack many resources for self-healing. The Resilient Housing Program (RHP) was created to support community development by providing technical and financial supports for disadvantaged households to build safe houses, thereby mitigating the adverse impacts of natural disasters such as storm, flood, climate change...on their daily lives. RHP has been implemented since 2013 under the auspices of Foundation for Supporting and Development of Sustainable Living Community (Sống Foundation) in many provinces in Vietnam.

In 2021, this Foundation implements RHP for the first time in Thua Thien Hue province. In that spirit, RHP supports disadvantaged households in 2 communes of Quang An and Quang Tho to build safe houses with architectural and technical support from the Faculty of Architecture, Hue University of Sciences. Therefore, within this poster, we will focus on introducing the houses built in these 2 communes.



Fig.1. Building safe house for beneficiaries

### APPROACH

The project's approach is based on building and maintaining a strong relationship between beneficiaries, local authorities, RHP and other supporters such as construction providers, volunteer networks.



Fig.2. Participatory approach of Resilient Housing program

### IMPLEMENTATION PROCESS

RHP examines and supports the most in-need households with 7 selection criteria as following:

- Families living in areas affected by natural disasters or impacts from climate change;
- Families who have both need and motivation to build safe housing;
- Families who are poor, near-poor, or families with other difficulties;
- Families having multiple children;
- Families having legal ownership of their land with no disputes and not in areas planned for government required relocation;
- Families committed to deep involvement in the design process and comply with project requirements;
- Families capable of contributing financially to the house construction (at least 50% of the construction cost, roughly VND 45 - 50 million).



Fig.3. Meeting with beneficiaries

Based on 07 criteria to select households to support building safe houses. We hold meetings, conduct field surveys, understand about the circumstances and impacts of storms and floods on their lives. Then we co-design and discuss the construction plan with the landlord. After that, the construction process was carried out under the close supervision of RHP, Faculty of Architecture and local authorities.



Fig.4. field surveys and construction process supervision

Faculty of Architecture has come up with plans to ensure both saving and safety based on reciprocal ability of families. Accordingly, all permanent houses have attic floors to avoid floods, with construction costs under 220 million Vietnam dong.

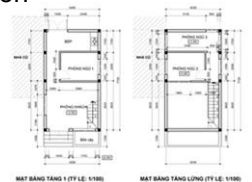

Fig.5. Archirectural drawing of safe house in Quang An

### RESULTS

Thua Thien Hue is the new operating area in 2021 of RHP in the Central region. Despite many difficulties like Covid-19, we support the survey, co-design, construction and completion of 7 safe houses in Quang An and Quang Tho . These finished houses are gifts right before the stormy season for households.



Fig.6. 07 completed houses in Q.A & Q.T

### ARCHITECTURE FACULTY & SỐNG FOUNDATION

Architecture Faculty – University of Sciences – Hue University (Established since 1995)  
Address: 77 Nguyen Hue st., Hue city, Vietnam - Phone: +84 234.3833530  
Email: [khoakientruc\\_dkh@emaildodo.com](mailto:khoakientruc_dkh@emaildodo.com) | Website: <http://huearch.husc.edu.vn/>  
Facebook: [www.facebook.com/khoakientruc](http://www.facebook.com/khoakientruc)

#### Organizational structure

Dean of Faculty: Dr. Arch. Nguyen Ngoc Tung  
The affiliated department:

- ❖ Department of Interior Architecture and Construction Technology
  - ❖ Department of Civil and Industrial Architecture
  - ❖ Department of Planning, Conservation and Landscap
- Lecturers: 24 (7 doctors, 2 PhD students, 11 masters, 2 engineers & 01 bachelor).



NHA CHÔNG LỬ  
HÀNH PHÚC XANH  
RIVER OI

Foundation for Supporting and Development of Sustainable Living Community (Sống Foundation)  
Address: Floor 6<sup>th</sup>, No. 67 Ly Chinh Thang st., Vo Thi Sau Ward, District 3, Ho Chi Minh

Email: [info@song.org.vn](mailto:info@song.org.vn) | Website: <https://song.org.vn/>  
Facebook: <https://www.facebook.com/songfoundation>

#### Organizational Structure

- (1) The Resilient Housing program - supporting disadvantaged families and communities in planning and building safe, climate-resilient houses
- (2) The Green Happiness program - afforestation and human connection with nature.
- (3) The RiverOi program - raising awareness and enhancing human capacity.

Acknowledgement: the research is support by Sống Foundation